

WE ARE GLASS PEOPLE

# BLOW MOULD COOLING VERTICAL AIR STREAM

Type 2214



# VERTICAL AIR STREAM (VAS)

The system is available for 5" SG, 5" DG, 5½" DG, 6¼" DG and 4 ¼" TG IS-Machines.

## Design VAS

The basic design of the blow mould cooling VAS consists of an upper and a lower housing. In between the butterfly valve is mounted.

The upper housing acts as pressure chamber and contains the vacuum supply and the bottom plate as well.

The lower housing forms the cooling air connection between the box and the upper housing. In addition, the height adjustment is mounted there.

In order to reduce the distance between centre line Invert and upper edge bottom plate a distance kit can be mounted.

## VAS direct flow

The lower housing forms the cooling air connection from the machine bed to the upper housing. The height adjustment is integrated.

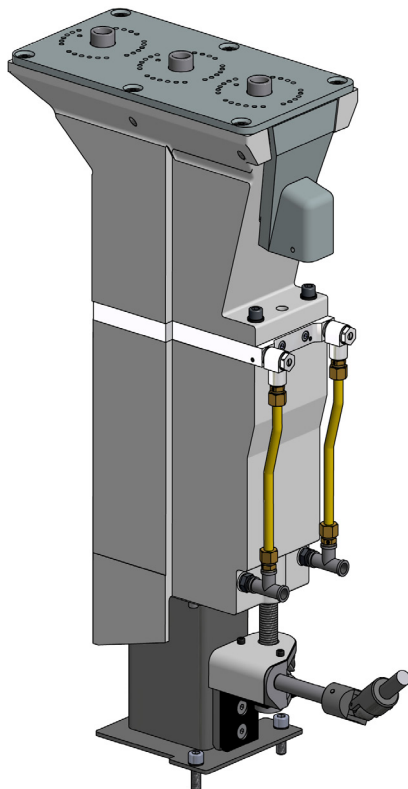
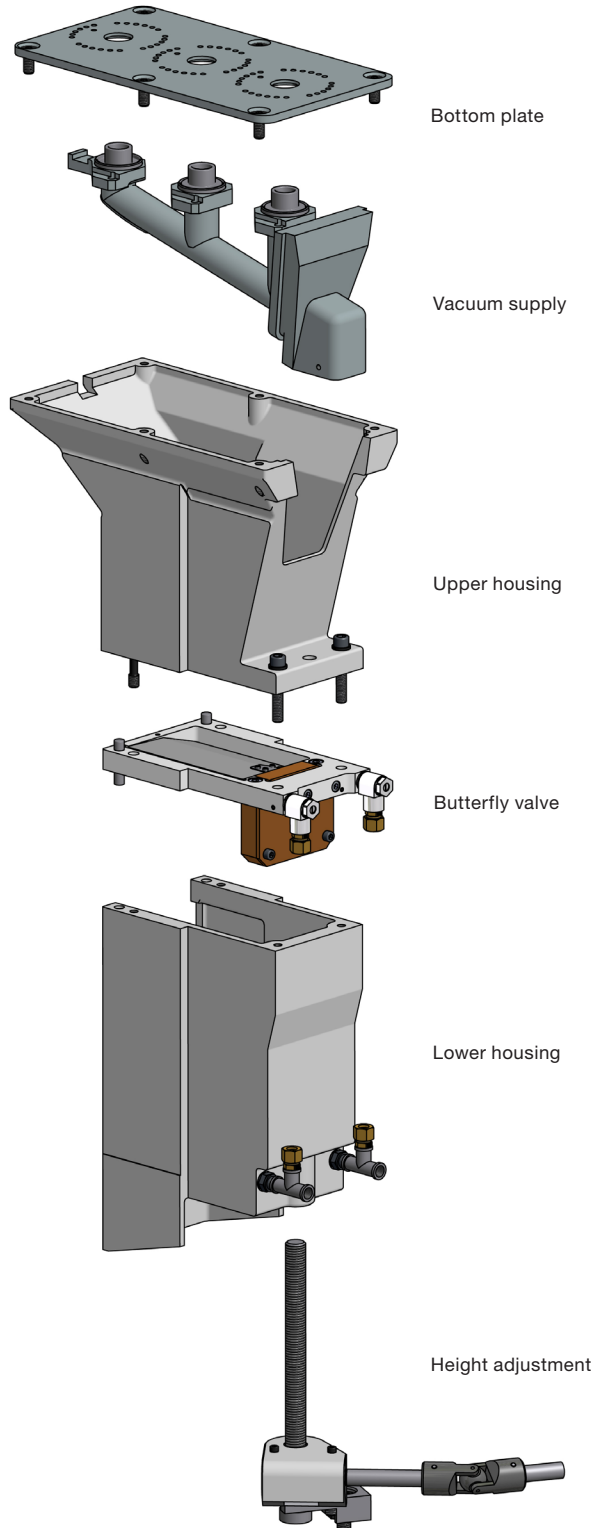

## FUNCTION

The Blow Mould Cooling VAS supplies the closed blow moulds with cooling air by an axial air stream.

Besides, it provides the vacuum for the blow moulds.

### Butterfly valve

A butterfly valve renders the intermittent operation possible. Opening and closing of the valve is timed by the E-Timer of the IS-Machine. To turn the butterfly valve a double acting cylinder is pressurised via the valve block with air (2.2 bar).

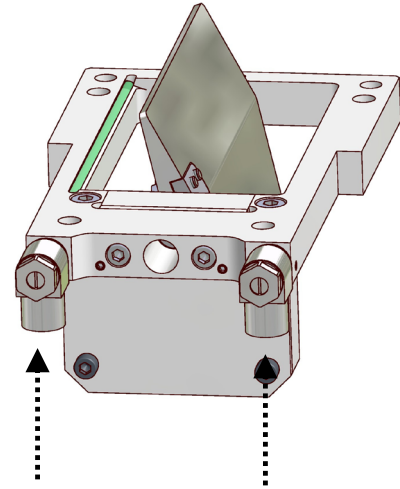

## PRINCIPLE OF THE BUTTERFLY VALVE

### Closed butterfly valve:

- The blow mould will not be cooled
- Vacuum off

### Opened butterfly valve:

- The blow mould will be cooled
- Vacuum on: Air is sucked from the blow moulds

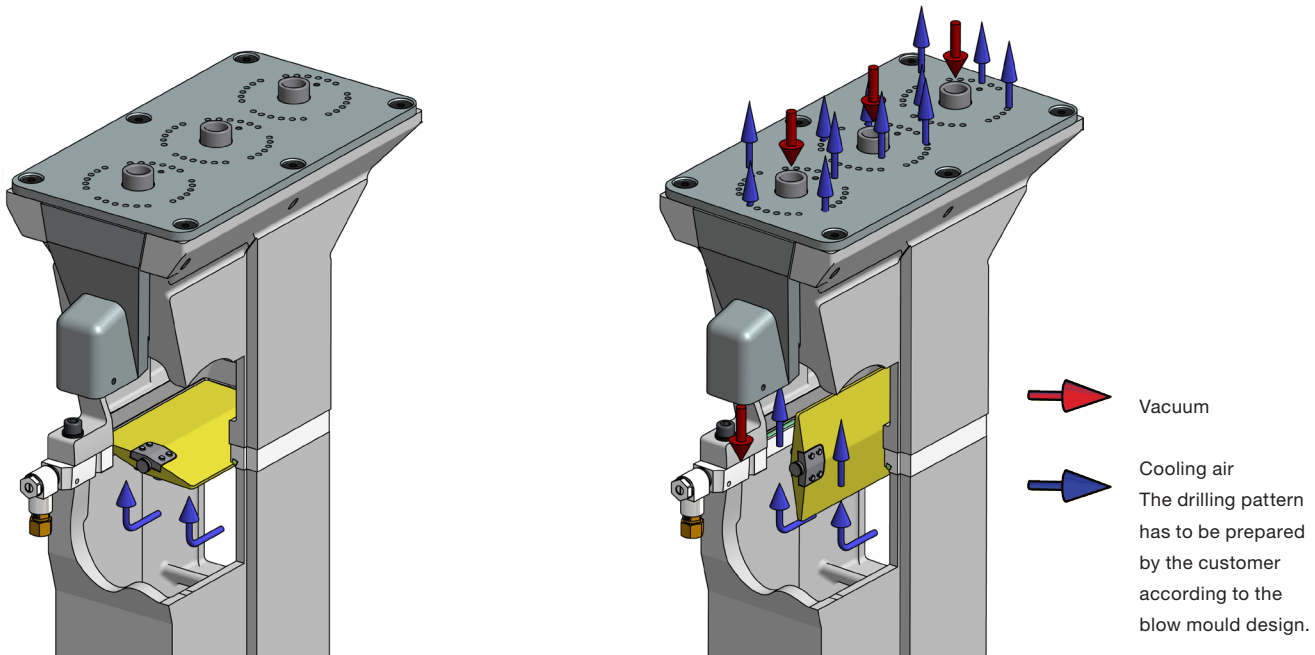

# OVERVIEW

## Advantages

- The movement of the butterfly valve is independent from the cooling air pressure. Thus, the Blow Mould Cooling VAS operates very reliably
- Optimised flow conditions provide for a homogenous distribution of the cooling air in all drillings of the bottom plate
- The system can be supplied for 5" SG, 5" DG, 5½" DG, 6¼" DG and 4 ¼" TG IS-Machines
- A conversion from SG to DG or vice-versa, DG to TG or from TG to DG is easy to handle. Only the upper parts of the housing must be exchanged
- The IS box must not be modified for the installation. The Blow Mould Cooling VAS is fully interchangeable (except "direct flow")
- Maintenance work can be carried out very simple and fast (e.g. simple exchange of the vacuum supply)
- For very short articles special spacers are optionally available

## Scope of Delivery

- VAS unit
- Adapter with distance frame

**Heye International GmbH**  
Lohplatz 1, 31683 Obernkirchen  
Germany

T +49 5724 26 452  
F +49 5724 26 229

[www.hey-international.com](http://www.hey-international.com)